

# Burney Gaines Cemetery

The Burney Gaines Cemetery is located .5 miles east of Burneyville, Oklahoma, in southern Love County (figure 1). This cemetery sits atop a hill overlooking former Col. Gaines' farm in the 1870's. Information about the abandoned Chickasaw cemetery was gathered in response to a citizen's initial inquiry in 2012 and mailing an application to the cemetery preservation program in 2013. The cemetery location was determined to be within the Chickasaw Nation reservation, and with research, marked graves were confirmed to be of Chickasaw lineage. A work plan was developed with the landowner and the cemetery preservation specialists provided cleanup services which included brush and limb removal, and fence and headstone repair.



Bill Anoatubby, Governor

**FIGURE 1**

The Chickasaw Nation's 13 1/2 county territory (purple outline) and the location of the Burney Gaines Cemetery (yellow dot).

Map layers provided by the Chickasaw Nation GeoSpatial Information (GSI) Department.



**FIGURE 2**

The 1872 Bureau of Land Management survey map and the current location of the cemetery (yellow dot). No cemetery was documented on the map but Col. Gaines' farm is shown in great detail. The town of Burneyville was not yet established but is noted.

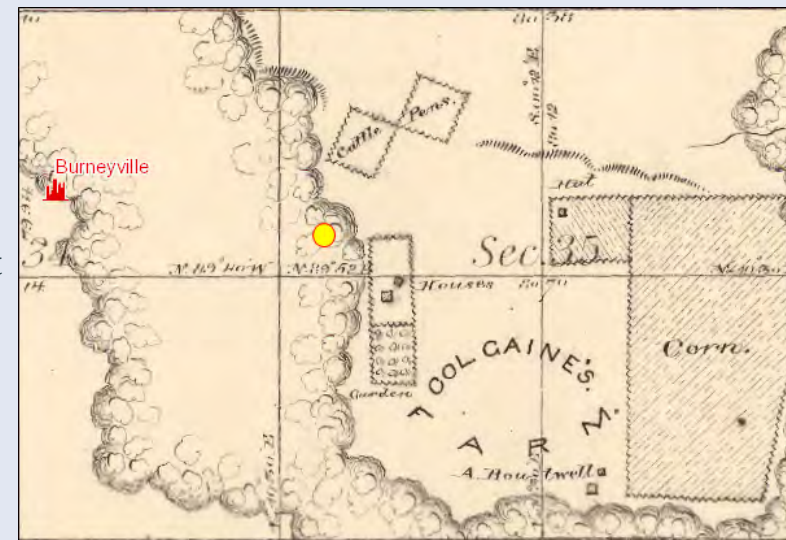

Map layers provided by Google Earth Pro (2019).

**FIGURE 3**

Location of the Burney Gaines Cemetery (yellow dot) on the allotted land of Lillie May Burney (IW#395), the wife of Albert Sidney Burney (son of Wesley Burney and Mary Gaines). Albert's allotted land and the allotted land of his two sons (Joseph and Sidney) are to the north and southeast of the cemetery. Albert's father's allotted land, Wesley Burney (R#1742) and the allotted land of Albert's half siblings (Una, Clay P., Douglas Johnson, Valey and Blanch) are located to the west of the cemetery.

Allotment map provided by the Chickasaw Nation GeoSpatial Information (GSI) Department.

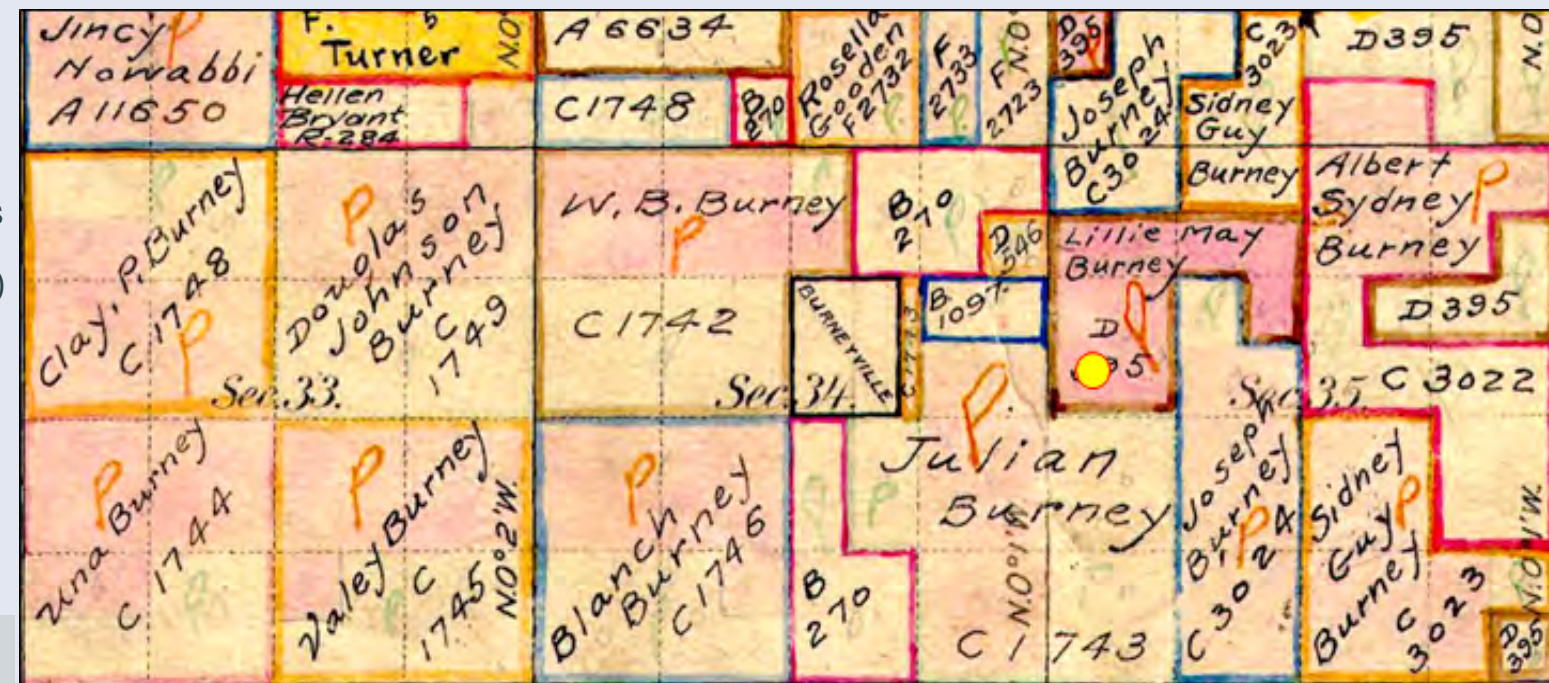

**FIGURE 4**

BEFORE



The Burney Gaines Cemetery before cleanup. Headstones were not visible and knocked over or broken.

AFTER



The view after cleanup services provided by cemetery preservation specialists.